



Presents



VRB GROUP OF COMPANIES

SOOD VIHAAR

BORKHRA, LADPURA,
KOTA, RAJASTHAN





ABOUT SOOD VIHAAR

SIZE OF TOWNSHIP: 31 BIGHA

Keeping in mind the general nature of the Rajasthan and the city, Sood Vihaar is lush-green, pollution-free, and provides an environment where any common person would dream to live with family, friends, and colleagues.

Borkhura, Ladpura, Kota, Rajasthan

Rera No. RAJ/P/2023/2429



ENTRY GATE WITH BOOM BARRIER

SOOD VIHAR FEATURES AN ENTRY GATE TO THE COLONY ALONGWITH A BOOM BARRIER. FEATURING A GATED COMMUNITY AND ENHANCING THE SECURITY LEVEL THAT BUILDS FEELING OF SAFETY AMONG THE RESIDENTS.



CCTV CAMERA

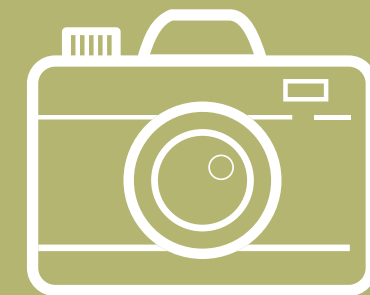

With the many benefits that CCTV cameras offer, it is no surprise that to ensure your security, we have installed several security cameras for your as well as your family's safety.

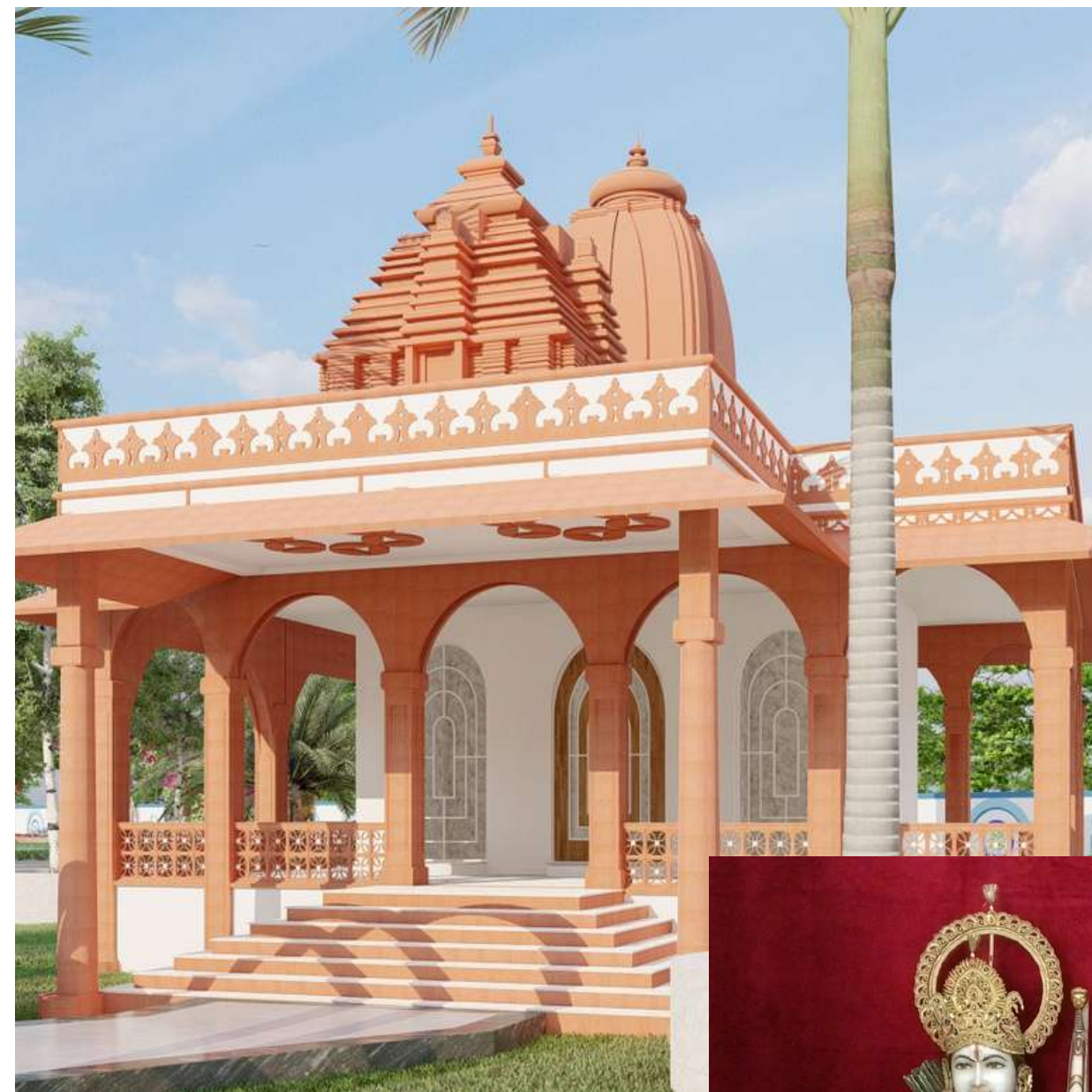

RAM DARBAR

The temple is open to visitors of all faiths and is a popular spot for tourists as well. The atmosphere is peaceful and serene, making it a perfect place for meditation and reflection.

Temple Size : 21'× 20'





COMMUNITY HALL



The community hall in Sood Vihar is a multipurpose space used for a variety of events and activities. It serves as a hub for social gatherings, cultural events, educational programs, and recreational activities.

Community Hall

Total Area : 4000 Sq. Ft.
Two Bedrooms of 12.5' × 10' size
One Green Room of 14' × 10'



VRB GROUP OF COMPANIES
BUILDING RELATIONS

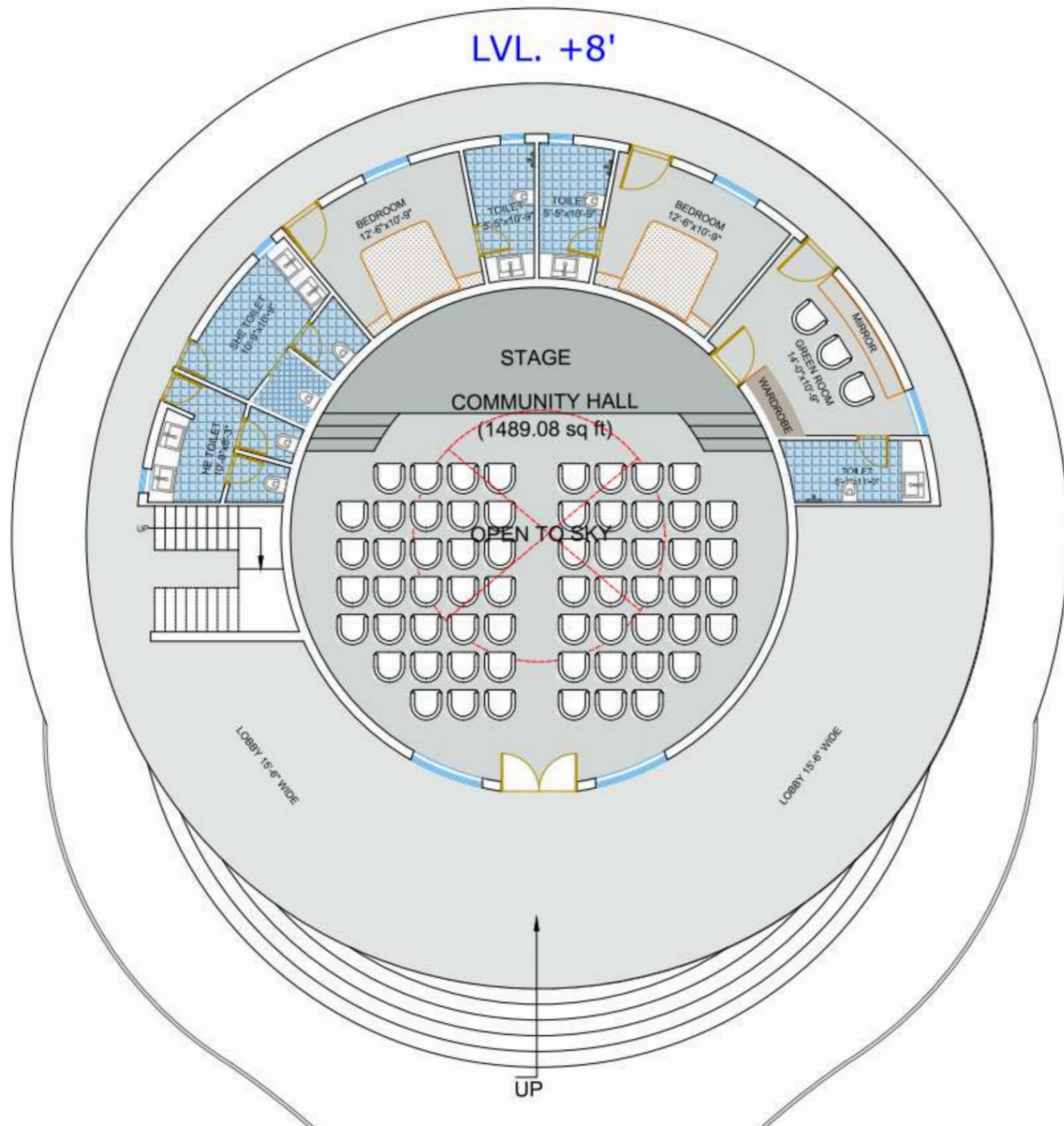

PLAN FOR COMMUNITY HALL



The community hall in Sood Vihar is a multipurpose space used for a variety of events and activities. It serves as a hub for social gatherings, cultural events, educational programs, and recreational activities.

Community Hall

Total Area : 4000 Sq. Ft.
Two Bedrooms of 12.5' × 10' size
One Green Room of 14' × 10'



SELFIE POINT ABSTRACT SCULPTURE

A selfie point featuring an abstract sculpture is a unique and interesting addition to any public space. A stone sculpture is a work of art that is created by carving stone into a specific shape or design. When combined with a selfie point, it provides an opportunity for visitors to take photographs with a beautiful and culturally significant work of art.





ACUPRESSURE PATHWAY



An acupressure pathway is a system of pathways or channels in the body that are used in acupressure therapy. Acupressure is a form of traditional Chinese medicine that involves applying pressure to specific points on the body to relieve pain and promote healing.

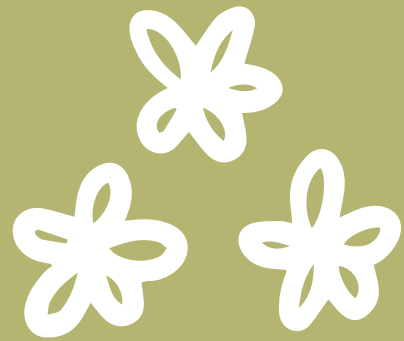

OPEN PLAYING ZONE

An open playing zone is a designated area within a public space that is specifically designed for outdoor recreational activities. These zones are typically found in parks, playgrounds, and other open areas and offer a range of activities for people of all ages to enjoy.



OPEN GYM



An open gym is a type of fitness facility that is located outdoors and is accessible to the public. These facilities typically provide a range of exercise equipment that is designed to be used outside, such as weightlifting equipment, cardio machines, and other types of fitness equipment.





GAZEBO

A gazebo is a freestanding, outdoor structure that provides a shaded area for people to relax and enjoy the outdoors.

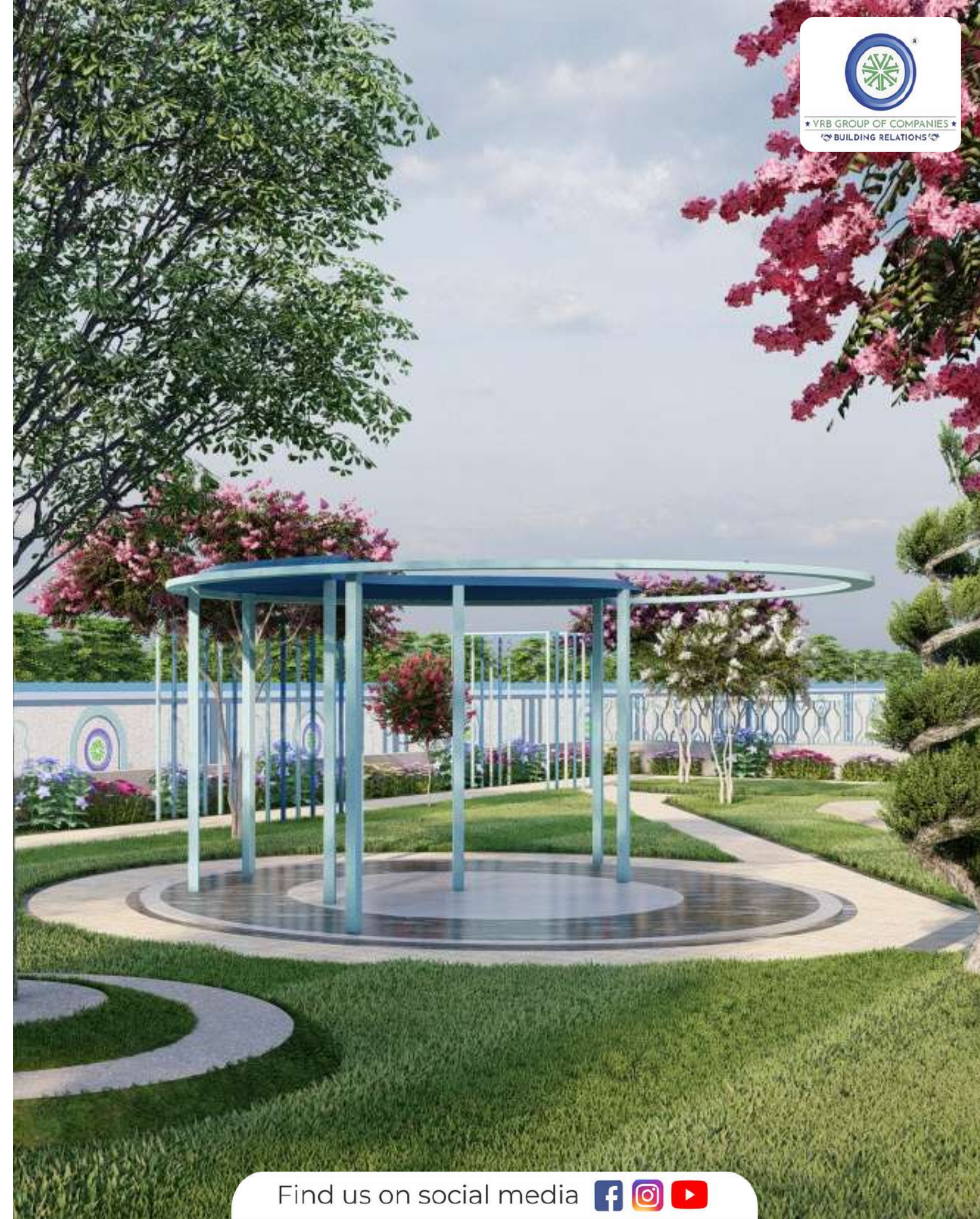



SITTING AREA

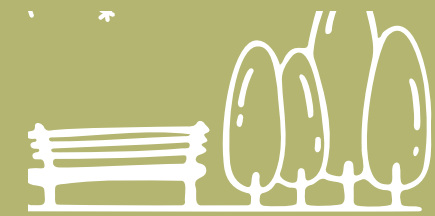

A sitting area in Sood Vihaar can provide a peaceful and relaxing space for people to unwind and enjoy the natural surroundings. These areas can be designed to promote mental health and well-being, providing a respite from the stresses of daily life.



YOGA ZONE

A yoga zone is a designated area within Sood Vihaar where individuals can practice yoga and other types of meditation or mindfulness exercises. Yoga zones are typically designed to provide a peaceful and relaxing atmosphere that promotes mental and physical well-being.





FLOWER MOUNDS



Flower mounds are raised beds or mounds of soil that are designed to create a decorative and visually appealing landscape feature. Flower mounds can be found in gardens, public spaces, and parks, and are often used to add color and texture to an outdoor area.



PERGOLA

A pergola is a freestanding outdoor structure that is designed to provide shade and support for climbing plants. Pergolas typically consist of a series of vertical posts or columns that support horizontal beams or rafters, which in turn support an open lattice or grid of crossbeams.

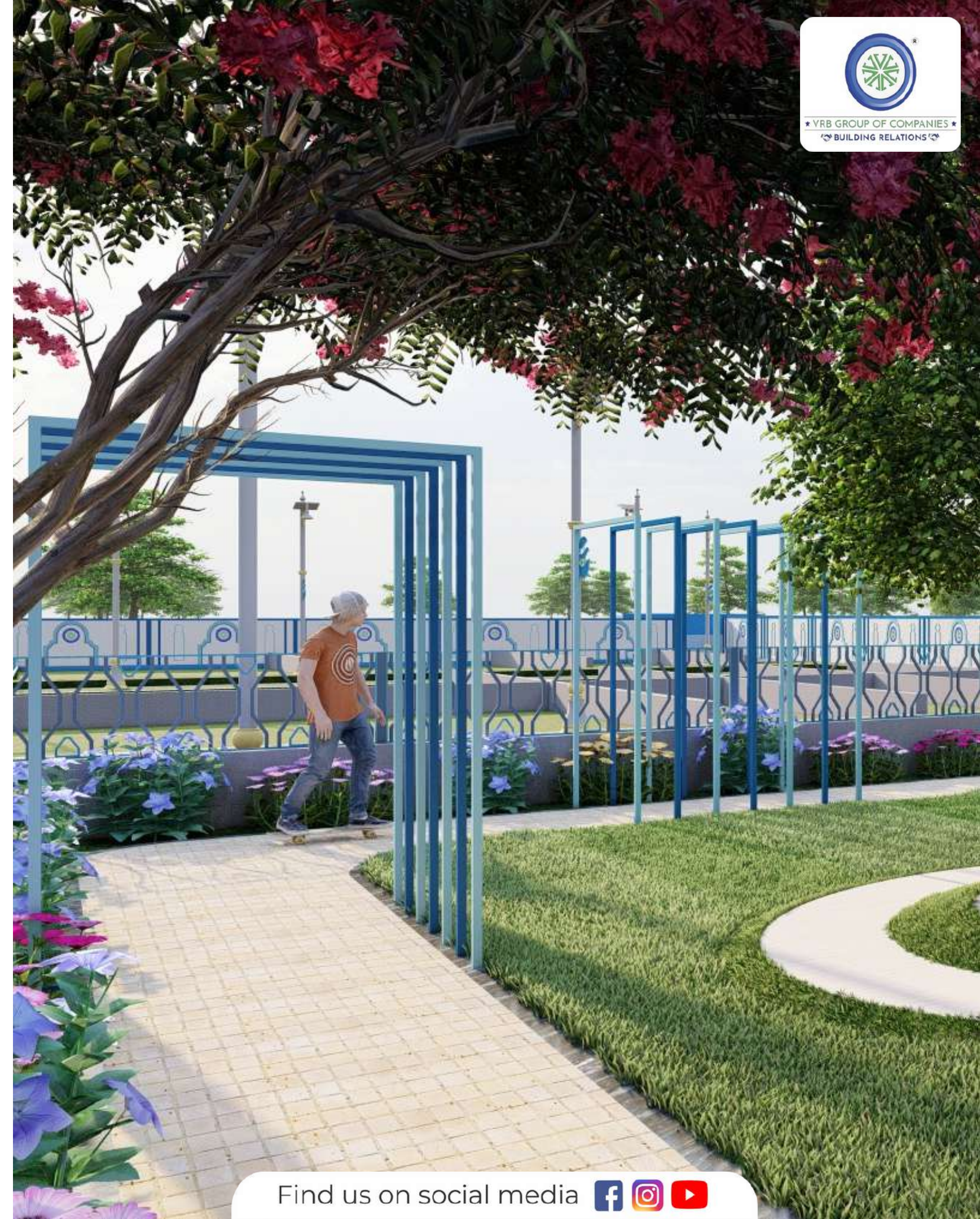



C.C. ROAD



A CC road (Concrete Cement road) is a type of road surface that is made of concrete and cement. CC roads are commonly used in urban and suburban areas where heavy traffic and harsh weather conditions can cause damage to traditional asphalt roads.



COMMERCIAL PLOT AREA

It is typically designed with features that are specific to commercial use, such as large display windows, signage space, and storage areas. They may also be equipped with utilities such as water and electricity, and may have access to shared amenities such as restrooms and parking facilities.





STREET DEMARCATATION

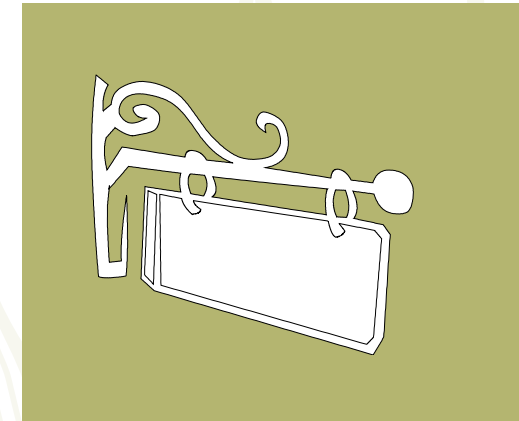

Street demarcation refers to the process of marking or delineating boundaries and designating areas on public streets.

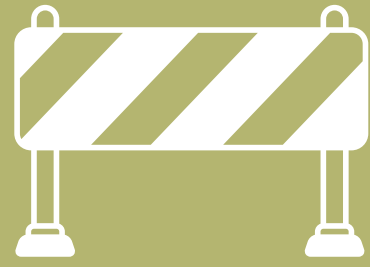

OUTER BOUNDARY WITH WIRE FENCING

Wire fencing is a popular option for outdoor boundaries due to its durability, affordability, and effectiveness in deterring unwanted entry or trespassing. It can also be used to keep animals and wildlife from entering a property, and can help to protect crops or other vegetation from damage.





PLOT DEMARCATION

Plot demarcation refers to the process of marking or delineating the boundaries of a piece of land or property. This is typically done using a range of physical markers, such as stakes, fencing, walls, or pavement markings.

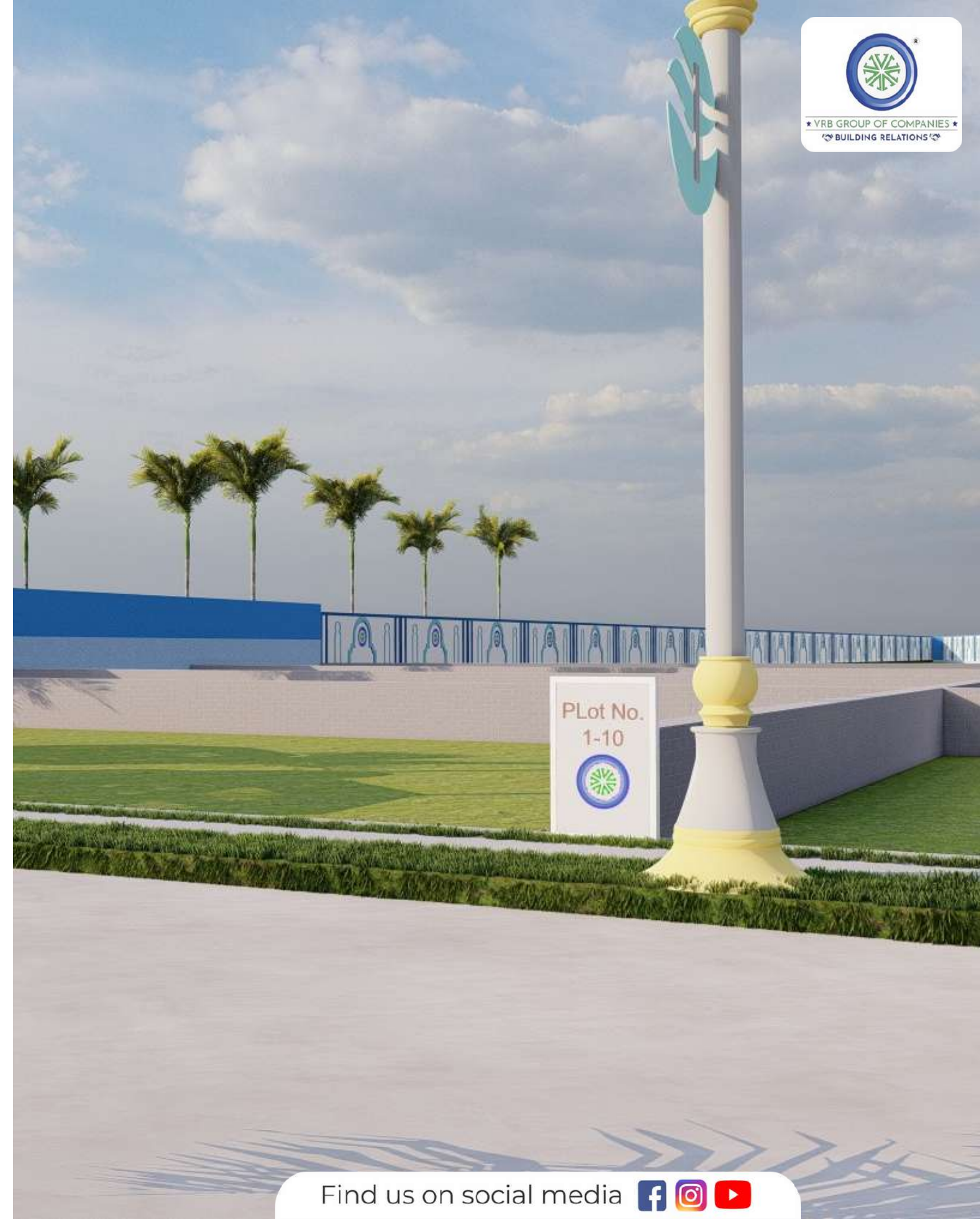

LED STREET LIGHT



A LED street light is a type of outdoor lighting fixture that uses light-emitting diodes (LEDs) to illuminate streets, roadways, and other outdoor areas. LED street lights are becoming increasingly popular as a more energy-efficient and cost-effective alternative to traditional street lights that use high-pressure sodium or metal halide lamps.



OVERHEAD WATER STORAGE RESERVOIR (OHSR)

Sood Vihaar features Overhead Water Storage Reservoir, Clear Water Reservoir & a pump house to ensure that water is running through all the houses and plots 24x7.

OHSR CWR 1.5 LAKH LITER





PARK BENCHES



Park benches are outdoor seating areas typically found in parks, gardens, and other public areas. They are designed to provide a comfortable and convenient place for people to sit and rest while enjoying the surrounding scenery.

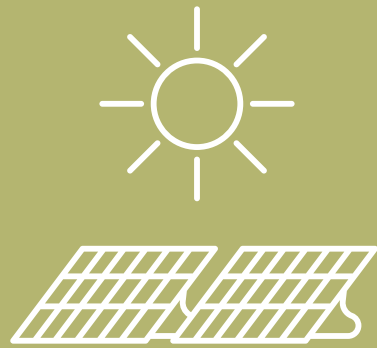

SOLAR PLANT FOR COMMON FACILITY

A solar plant for a common facility is a type of renewable energy system that uses solar panels to generate electricity for a shared building or facility. Solar power systems are becoming increasingly popular as a sustainable and cost-effective alternative to traditional fossil fuel-based energy sources.

SOLAR PLANT 10 KW





UNDERGROUND SEWERAGE TREATMENT PLANT



An underground sewerage treatment plant is a facility that treats wastewater from homes and businesses to remove pollutants and contaminants before releasing it back into the environment. These treatment plants are designed to be located underground, making them less obtrusive and minimizing their impact on the surrounding landscape.



COVERED UNDERGROUND NAALI



Sood Vihaar features Underground Covered Naali for the convenience of residents and people alike.



UNDERGROUND WATER PIPELINE

An underground water pipeline is a system of pipes that are buried underground and used to transport water from one location to another. These pipelines are typically made of materials such as PVC, HDPE, or steel, and can range in size from small pipes used for residential water supply to large pipes used for industrial or municipal water supply.



UNDERGROUND SEWERAGE PIPE LINE



An underground sewerage pipeline is a system of pipes that are buried underground and used to transport wastewater from homes and businesses to a treatment plant for processing.



UNDERGROUND ELECTRICITY LINE

An underground electricity line is a system of cables that are buried underground and used to distribute electrical power from a generating station to homes, businesses, and other electrical loads.





BOREWELL

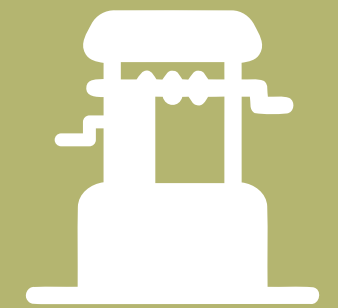

A borewell is a narrow shaft that is drilled into the ground to access groundwater. The purpose of a borewell is to provide a reliable and sustainable source of water for domestic, agricultural, or industrial use.

NEARBY PLACES

BELOW MENTIONED ARE SOME OF THE NEARBY PLACES & INSTITUTIONS TO HELP YOU COMMUTE, ACCOMODATE YOUR TRAVEL & LIVE A HAPPY & PEACEFUL LIFE!



RAILWAY JUNCTION
KOTA (3 Kms. aprx)



RTDC BUS STAND
KOTA (5 Kms. aprx)



AIRPORT
(7 Kms. aprx)

NEARBY PLACES

BELOW MENTIONED ARE SOME OF THE NEARBY PLACES & INSTITUTIONS TO HELP YOU COMMUTE, ACCOMODATE YOUR TRAVEL & LIVE A HAPPY & PEACEFUL LIFE!



ALLEN CAREER INSTITUTE SUPATH CAMPUS (6 Kms. aprx)



JK LONE HOSPITAL (4 Kms. aprx)



MAHARAV UMMEED SINGH STADIUM KOTA (5 kms. aprx)



NEARBY ENTERTAINMENT

BELOW MENTIONED ARE SOME OF THE NEARBY PLACES & INSTITUTIONS TO HELP YOU COMMUTE, ACCOMODATE YOUR TRAVEL & LIVE A HAPPY & PEACEFUL LIFE!



RIVER FRONT
(6 Kms. aprx)



SEVEN WONDERS
PARK (6 Kms. aprx)



OXYZONE PARK
(8 kms. aprx)

INFRASTRUCTURE

BELOW MENTIONED ARE SOME OF THE NEARBY PLACES & INSTITUTIONS TO HELP YOU COMMUTE, ACCOMODATE YOUR TRAVEL & LIVE A HAPPY & PEACEFUL LIFE!



BARAN ROAD
(1.5 Kms. aprx)



JAIPUR KOTA RD.
(5 Kms. aprx)



AND SO
MUCH MORE...



Sales & Marketed by:



SOOD VIHAR



THANK YOU!

Please contact our representative for more information on Sood Vihaar.

Find us on social media

